



## JUNK SUBS

Junk Sub is used to catch and remove junks which are heavy to be circulated and preventing them from settling down at the bottom of the drilled hole.

Junk Sub is normally run just on top of the drill bit. Also, by running a junk sub above a scraper, driller gets a quicker and cleaner scraping job.

Typical junks are heavy debris and fallen objects such as drill bits, carbide mill tooth and bearings which are too heavy to be removed from the drilled hole through conventional circulation methods.

### Fabrication:

The Junk Sub is manufactured from high strength steel with rib guides to prevent the cup from being crushed and helps in guiding the junk sub through tight spots while pulling out of hole with the junk inside.

### Kindly Note:

Please mention the top & bottom connection required while ordering, if different from the below specifications.

Junk Sub can also be ordered with specific cup lengths required like 10", 20", 30" etc. Kindly mention the same in PO, if different from the below specifications.

Any other special requirement may please be specified along with the purchase order.

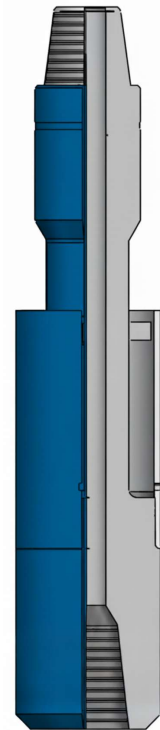

### Specifications:

Model Description	3 11/16	4	4 1/2	5	5 1/2	6 5/8	7	8 5/8
Top Connection	2 3/8 Reg Pin	2 7/8 Reg Pin	3 1/2 Reg Pin	3 1/2 Reg Pin	3 1/2 Reg Pin	4 1/2 Reg Pin	4 1/2 Reg Pin	6 5/8 Reg Pin
Bottom Connection	2 3/8 Reg Box	2 7/8 Reg Box	3 1/2 Reg Box	3 1/2 Reg Box	3 1/2 Reg Box	4 1/2 Reg Box	4 1/2 Reg Box	6 5/8 Reg Box
Bore Diameter	3/4	1 1/4	1 1/2	1 1/2	1 1/2	2 1/4	2 1/4	3 1/2
OD of Body (fishing neck)	3 1/8	3 3/4	4 1/4	4 1/4	4 1/4	5 1/2	5 1/2	7 3/4
OD of Body (under cup)	2	2 5/8	3 1/8	3 1/4	3 1/4	4 1/2	4 1/2	5 3/4
ID of Cup	3 5/16	3 5/8	4 1/4	4 9/16	4 7/8	5 15/16	6 9/32	7 15/16
OD of Cup	3 11/16	4	4 1/2	5	5 1/2	6 5/8	7	8 5/8
Cup Length	10	10	10	10	10	10	10	10
Tool Length	29	29.5	35	37	37	40	40	41

\* All dimensions are in inches.

\* Above table is only for reference purpose only. We can manufacture the tool as per client requirement.